

▲  
**GARSONIERA**  
 $S=37,90$  mp

E.1 ap. 9,  
 E.2 ap. 17,  
 E.3 ap. 25

E.1 ap. 13,  
 E.2 ap. 21,  
 E.3 ap. 29

**G A R S O N I E R A**

CAMERA 18,10 mp  
 BUCATARIE 8,60 mp  
 BAIE 5,00 mp  
 HOL 6,20 mp

**SUPRAFATA UTILA 37,90 mp**

BALCON 4,50 mp

**TOTAL 42,40 mp**

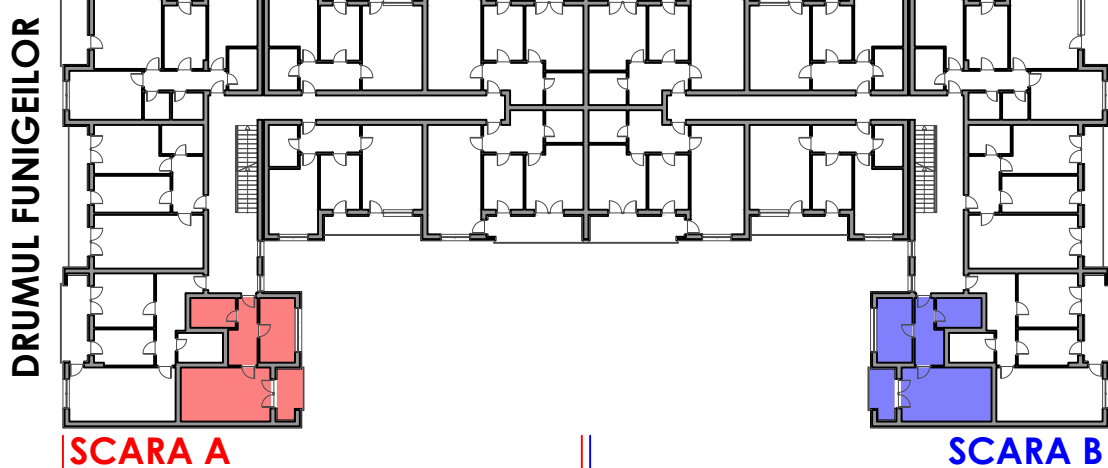
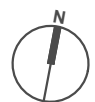

**BLOC 1**

SUPRAFETELE SUNT CALCULATE LA ROSU SI NU INCLUD ERORILE DE EXECUTIE